

CLEANING PROCEDURE | DYCEM® LITE MATS

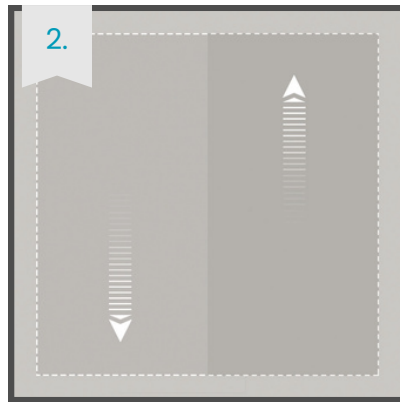

1. For optimal performance, daily cleaning is recommended. Clean the subfloor per facility protocol and remove excess liquid with a flat mop or squeegee system, ensuring a dry surface.



2. Clean the subfloor, agitating with a flat mop or hard foam squeegee, in a vertical direction, and remove excess residue/liquid. Repeat horizontally.



3. Fold over the Lite mat halfway and clean the underside of the mat using a flat mop or an isopropyl alcohol wipe (70/30 IPA recommended). Repeat the process on the other side and allow it to dry.



4. Replace the Dycem mat on the subfloor. Using a spray bottle, mop, or pre-saturated wipe, apply the diluted cleaner to the mop or the mat ensuring complete coverage.



5. Using a flat mop or a squeegee, agitate the surface of the mat lifting the retained particulates. Working from closest to the controlled area past moving outwards, agitate in both a vertical and horizontal direction for maximum contamination removal.

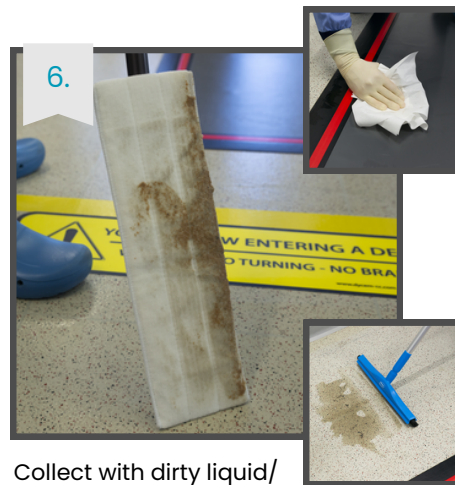

6. Collect with dirty liquid/residue with a sponge, flat mop, or wipe and dispose per facility mandated SOP's. For heavily saturated mats, repeat cleaning steps 1-6 until the liquid removed is visibly clear.

Tips & Advice

- For maximum performance, clean your Dycem mats at least once a day (or as advised by your specialist) with the following:
 - InSpec N10 or approved cleaner
 - Spray bottle or mop
 - Flat mop or squeegee system
- DON'T FORGET to clean the underside of the mat and the subfloor.
- After cleaning the Dycem, wash out any equipment so that it is ready to reuse.
- To remove built-up spot contamination clean with a 70/30 isopropyl alcohol wipe.
- Where decontamination or sterilisation takes place using a phenolic or hydroxide, rinse as per the instructions. Otherwise a film will develop reducing the effectiveness of Dycem.
- **DO NOT USE** concentrated bleaching agents, scouring or abrasive powders, or cleaning machines with stiff brushes. Buffing or polishing machines will damage the surface, shortening the active working life of the Dycem.
- If you have any questions or concerns, please get in touch.

CONTACT@DYCEM.COM
0117 955 9921

